

CERTIFICATE OF LOCATION OF GOVERNMENT CORNER

NORTH QUARTER Corner of Section 23, Township 106N, Range 41W

5th Principal Meridian, State of Minnesota, County of Murray.

At the corner location shown on the sketch:

☒ On 11/05/2021 found a 3/4" REBAR DOWN 0.6', +/- 48' NORTH OF THE EAST/WEST CENTERLINE OF TRUNK HIGHWAY
DATE

☒ left monument as found ☐ lowered monument ☐ removed monument (explain)

☐ On _____ placed a _____
DATE

SKETCH OF REFERENCE TIES

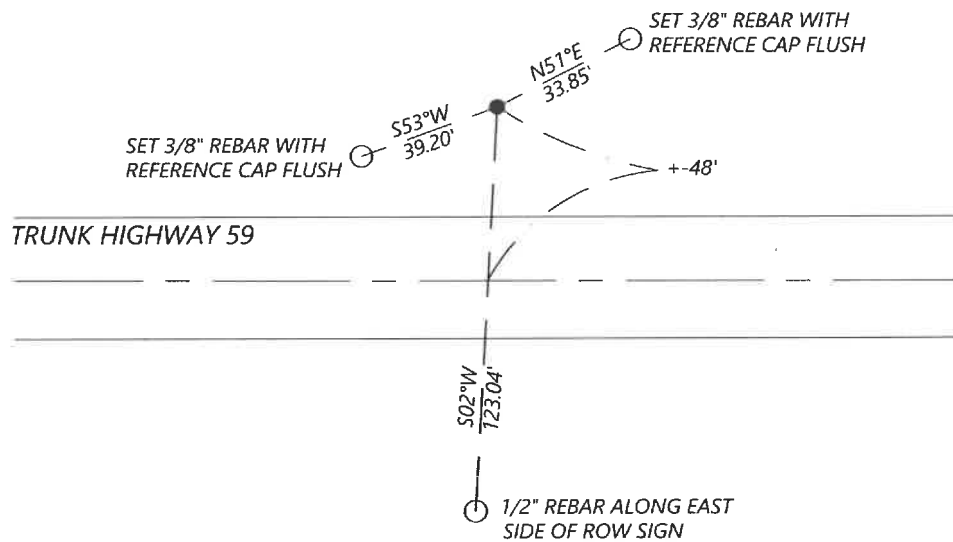

N.T.S.

Statement of evidence for this corner location is on back of this page.

I hereby certify that this document was researched and prepared by me or under my direct supervision and that I am a licensed Land Surveyor under the laws of the State of Minnesota.

Signature

Date 4-19-2022 License No. 57085

Title:

☒ *Land Surveyor* ☐ *Professional Engineer*
☐ *County Surveyor* ☐ *County Engineer*

OFFICE OF THE COUNTY RECORDER

County of Murray

I hereby certify that this

document was filed in the Co.

Recorder's office at _____ M. on the
22nd day of April _____ A.D. 20 22

County Recorder Karen Brown

by _____, Deputy

DOCUMENT NO.

SETH WECKMAN
Minnesota License No. 57085

Statement of Evidence:

North Quarter corner of Section 23, Township 106 North, Range 41 West, 5th Principal Meridian, Murray County, Minnesota.

1861 L.G.M. Fletcher, U.S. Deputy Surveyor, during the original public land survey a post was set and built mound with trenches, pits, and charred stake.

1972 Minnesota Department of Highways, Trunk Highway 59 Right of Way Map (S.P. 5104), notes that the quarter corner is 23.3' North of P.O.T. at St. 81+90.7

2001 Zieske Land Surveying (Perry Zieske, LS 23008), files a survey and shows a found 3/4" monument.

2009 Bueltel-Moseng Land Surveying, Daniel Bueltel (LS 43844), files a survey and shows a found 3/4" iron for the corner.

2010 Zieske Land Surveying (Perry Zieske, LS 23008), files a survey and shows an iron monument, 48.3ft North of T.H. NO. 59 centerline.

2012 Zieske Land Surveying (Perry Zieske, LS 23008), files a survey and shows a found monument.

2021 Westwood Professional Services searched the area and found a 3/4" rebar, down 0.6ft. The found monument is +/- 48ft North of the East/West road centerline. The distance to the Northeast corner of Section 23 matches the 2009 Bueltel-Moseng survey, however it does not match the 2012 Zieske survey. No reference ties were found at the corner location. Accepting the found monument as the corner position and established 3 local reference ties.

Analysis of the recovered data, field evidence and survey measurements, indicates that the monument found is the correct perpetuation of this corner. For additional information concerning this corner please contact Westwood Professional Services.